

Robertson Graveyard

(A.K.A. McKinstry, D. M. Robinson)
By Dave Hallemann

This cemetery is located on the old Dr. Karl M^cKinstry (1950s-80s) property in E ½ of the SW ¼ of Township 40 north Range 4 east Section 36 at latitude 38 degrees 9 minutes 5 seconds north, 90 degrees 32 minutes 2 seconds west. From De Soto turn right (east) on Hwy 110, left (north) on Fountain City road, turn about 1 mile on left (north) onto M^cKinstry Road. Top of hill, park at house, get permission, walk across field to east, just inside tree line. Recorded on 16 May 1984 by Jean O'Brien, Helen and Frank Magre, and revisited on 21 March 1999 by Betty Olson, Becky Gagnon, Bill Reich, Glee and Jim Heiligttag-Naes, Jean O'Brien, and Dave Hallemann.

This cemetery is located on top of a hill overlooking the valley that Hwy 110 runs through. It is overgrown and needs restoration. Many sunken graves with no monuments. A few broken and undistinguishable stones.

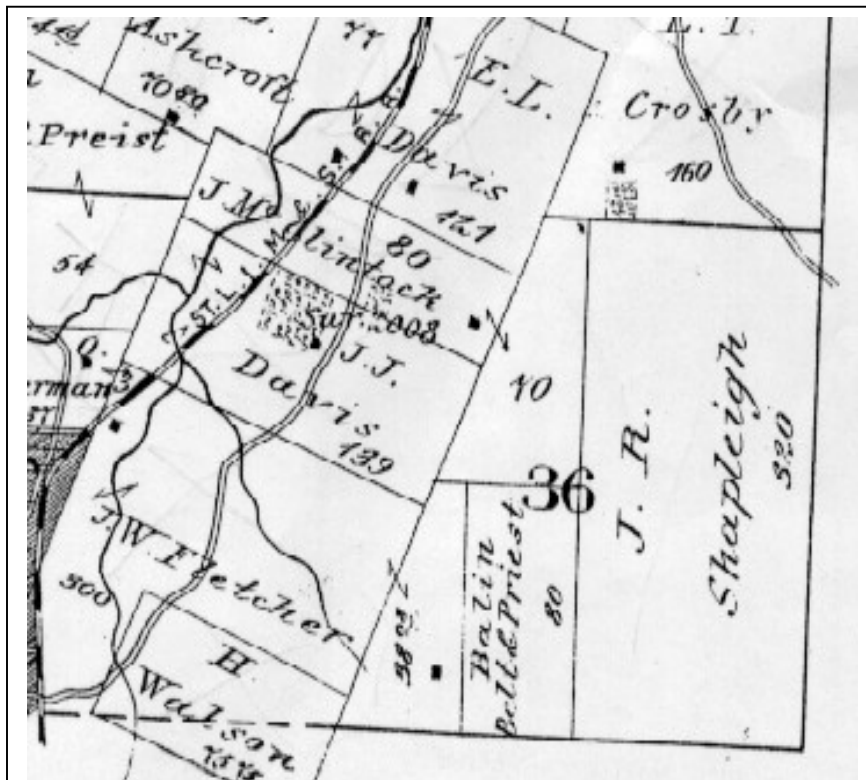

1876 Atlas T40 R4 Sec 36

In 1876 the land where the cemetery resides was located on the Balin, Belt and Priest's 80 acre tract about where the letter A or L is in Balin. J. W. Fletcher owned the 300 acre tract in Survey 2008 and the adjoining 38.08 acres that was the old Hendrickson homestead.

As an interesting note James B. Bowlin originally entered the Balin, Belt & Priest tract. Could *Balin* and *Bowlin* be the same? In other sections he is named *Bolin*, Belt & Etal.

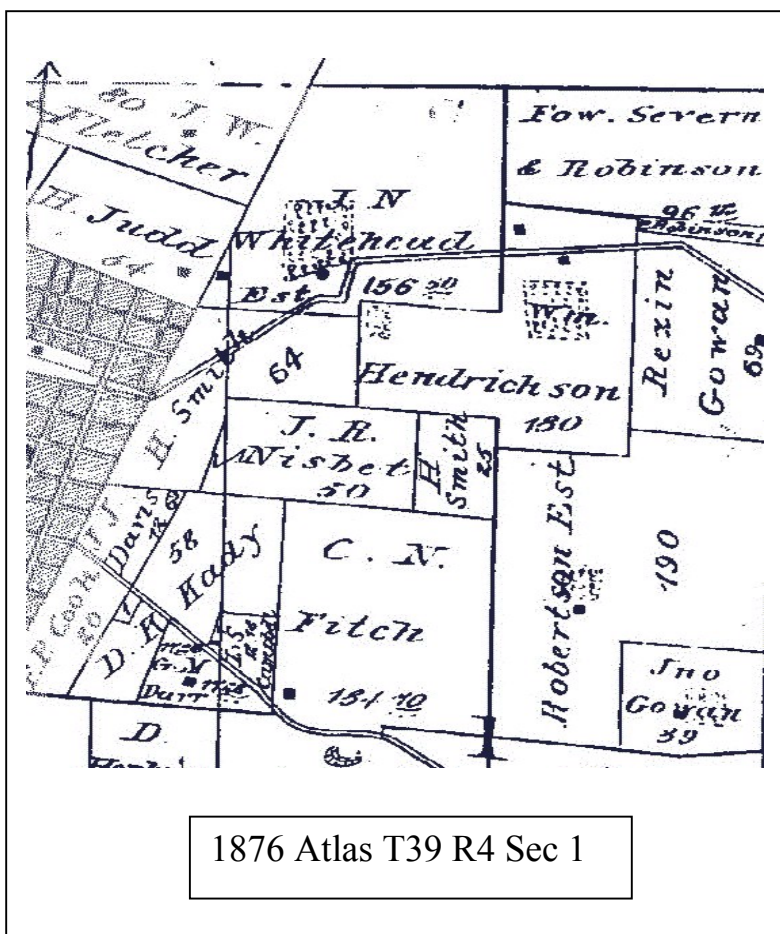

As can be seen to the left the 1876 Atlas has a Wm. Hendrickson in T39 R4 Sec 1, on 180 acres next to J. N. Whitehead's EST. of 156.50 acres. Betty Olson heard at one time the name of this cemetery was Robinson Cemetery. Here again we have Fow. Severn, & *Robinson*.

J. N. Whitehead's property is about ½ mile east of De Soto, directly south and adjoining the Hendrickson tract as section 36 adjoins section 1 on the north border.

You can see a Robertson EST. (Estate) of 190 acres, house and orchard about ½ mile south of the Balin, Belt, Priest property.

By 1898 we can see that in section 36 M. Eagan owns the tract and Richardsons own the land to the east of the cemetery.

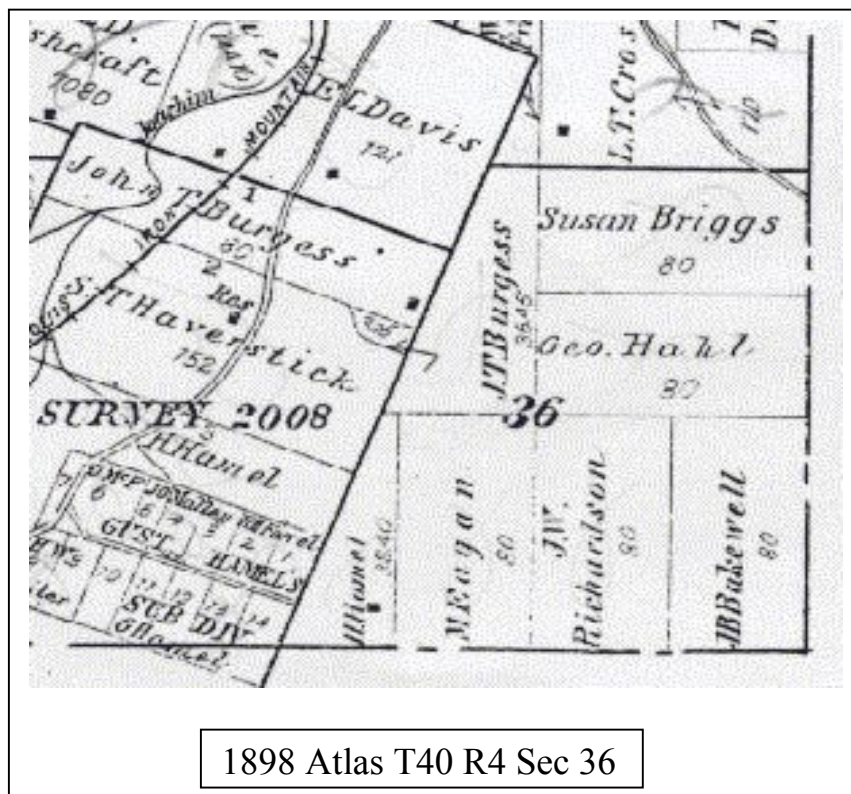



And again in 1898 in Section 1 we note that the Fow. Severn, & Robinson tract is now owned by W. R. Donnelly (this should be Donnell), as well as the Hendrickson and other tracts. The Whitehead Heirs still own property in section 1, as do Robertsons.

This E $\frac{1}{2}$ of the SW $\frac{1}{4}$ the cemetery is located on, along with other tracts, was originally entered by **James B. Bowlin** at the government land office in St. Louis on 10 October 1853 Certificate Number 21051 and comprised 80 acres. *see Document 1 below;*

James B. Bowlin and wife Margaret of St. Louis defaulted on a deed of trust issued on 22 October 1873 and recorded in Book 6 Page 576. By court order the Sheriff on 18 May 1878 sold the various parcel of land, including this tract used to secure the loan, on the courthouse steps at St. Louis to George H. Loker, as recorded in Book 12 Page 636. For the tract the cemetery is located on, the E $\frac{1}{2}$ of the SW $\frac{1}{4}$ of Section 36, George paid \$1.⁵⁰ an acre or \$120.⁰⁰ for this 80 acres.

On 18 June 1883, as recorded in Book 23 Page 301, William Marshall assignee of George Loker, William N. Loker, and G. H. Loker & Brother transfer title to William N. Belt the various tracts of land including "E $\frac{1}{2}$ SW $\frac{1}{4}$ Sec 36 T40 R4 containing 80 acres more or less". According to the deed on the 25 September 1878 all George Loker's heirs assign their right, and "Mary Loker wife of George Loker relinquishes her dower to William Marshall for \$350.⁰⁰", the above mentioned lands.

On the same day, 18 June 1883, Wm. N. Belt and wife Carrie M. sells to Benjamin Nichols *only* the “E ½ SW ¼ Sec 36 T40 R4 containing 80 +/-“ for \$200.⁰⁰ as recorded in Book 23 Page 366.

Three years later Benjamin Nichols uses the “E ½ SW ¼ Sec 36 T40 R4 containing 80 acres” to secure a loan from David M. *Robinson* for \$700.⁰⁰ as recorded in Book 25 Page 86. In this deed of trust Nichols agrees to 4 annual payments and amounts specified, also “...wood cut in excess of use of the farm, all racked and subject to the written order of said Benjamin Nichols, and to be sold in bulk and proceeds to apply to the credit of D. M. Robinson’s note or notes...” This deed of trust was signed by Benjamin Nichols. (Three items of interest here, first whoever wrote this deed of trust used the name *Robinson* throughout, second there was a farm on the property, third as this tract was close to De Soto and the railroad yards Robinson, who loaned money on the land, did not want Nichols to strip the land of wood without using the proceeds to pay off his debt. A *possibly* practice of the time could have been to buy land under deed of trust, then cut all the wood to sell to the railroad and then default on the loan, leaving with the money for the wood. The original owner would get his land back but the wood would be gone.)

The next warranty deed I came across was issued on 13 October 1886 from Benjamin Nichols and wife Anne of Jefferson County, to David M. Robertson for the sum of \$450.⁰⁰, as recorded in Book 30 Page 340, “All of the E ½ SW ¼ Sec 36 T40 R4 containing 80 acres, more or less. Being the same property described in a certain bond for deed made by said Benjamin Nichols to said David M. *Robertson* recorded in Book 25 Page 86 executed 30 July 1883.” (This is proof that the *D. M. Robinson* in the above document was in fact *David M. Robertson*.)

David M. Robertson and wife Amanda B. retains title to the land for the next eleven years. On 27 November 1897 they sell it to Michael Eagan for \$1600.⁰⁰ as recorded in Book 46 Page 318 to wit; “E ½ SW ¼ Sec 36 T40 R4 ***except 1 acre about the middle on the west line now used as a cemetery.*** Subject to deed of trust of which principal and interest remaining unpaid about four hundred ^{xx}/₁₀₀ dollars.” David Robertson could not write and signed with his mark X. (This is the first mention of a cemetery in the records on this tract. Also note the amount of acreage going from 80 to 79. Remember M. Eagan owned the land in 1898 when the Atlas was published, however no cemetery is shown, see picture above. At the same time as recorded in Book 46 Page 319 Michael Eagan and wife Mary, sell to Amanda B. Robertson lots 14, 15, 16, 17 Block 2 of C. C. Fletchers 1st Addition to De Soto, subject to a note Deed of trust dated 10 October 1894 to W. L. Fletcher of which about \$60.⁰⁰ is remaining.)

On 29 June 1903 just five years later Michael Eagan and wife Mary *of Wayne County, Mo.* sell the land to W. Patterson and George A. Patterson the “E ½ SW ¼ Sec 36 T40 R4 except one acre ***known as the Robertson Graveyard.***” as recorded in Book 54 Page 621. (This is positive proof that this cemetery is named Robertson Cemetery.)

Three years later on 7 April 1916 George A. Paterson and wife Lydia of St. Louis transfer title of “All E ½ SW ¼ Sec 36 T40 R4 containing 79 +/- acres” to A. Ashley for \$2500.⁰⁰ as recorded in Book 81 Page 450.

In Book 94 Page 493, A. Ashley and wife Ora default on a deed of trust executed on 13 April 1916 recorded in Book 84 Page 567 to R. B. Jones trustee. R. B. Jones died and the Sheriff, as stipulated, assumes the responsibility and sells the land on the courthouse steps to W. R. Donnell on Saturday 24 June 1922. (This deed of trust was recorded just 6 days after the sale of the land to A. Ashley.)

25 January 1923, W. R. Donnell and wife M. Belle sell the tract to Eli D. Janis and Bertha his wife for the sum of \$2500.⁰⁰ "All E ½ SW ¼ Sec 36 T40 R4 containing 79 acres" as recorded in Book 95 Page 64.

17 May 1924, a little over a year later recorded in Book 97 Page 173, Eli D. Janis and wife Bertha sell the land back to W. R. Donnell for \$1.⁰⁰ "All E ½ SW ¼ Sec 36 T40 R4 containing 79 acres." Donnell in addition agreed to pay off a deed of trust owed by Janis recorded in Deed of Trust Book 62 Page 564 in the amount of \$2250.⁰⁰.

The next entry I found on this tract was where the Donnell heirs sold it to Henry Hodge and wife Linnie of St. Louis, their **4/5 interest**, for \$300.⁰⁰ on 24 January 1925, as recorded in Book 100 Page 183, "All E ½ SW ¼ Sec 36 T40 R4 79 acres". (I believe this was his brothers or partners as there was 4 names constituting the 4/5 interest.)

On the same date as above, 24 January 1925, between Emma D. Dodds and F. S. Dodds her husband of Philadelphia, PA., Laura D. Parham and D. P. Parham her husband of Chicago, Ill., W. R. Donnell JR. and Gertrude his wife, and M. Belle Donnell to Henry Hodge and Linnie his wife for \$1.⁰⁰ "All E ½ SW ¼ Sec 36 T40 R4 except and reserving therefore, **the graveyard** on said premises containing 1 acre +/-, totaling 79 acres" as recorded in Book 100 Page 185. (I believe this was his immediate family, his wife M. Belle, son W. R. JR., daughters Emma Dodds and Laura Parham, and was the remaining 1/5 interest.)

Here the trail was lost. I could find no transfer of title to the next person in line. I then went to 1980 and started running backward to find Dr. Karl M^cKinstry. His I found in 1959.

On 14 October 1959 Ben Jarvis and wife Irene sold the below property to Karl and Virginia M^cKinstry for \$100.⁰⁰ "All E ½ SW ¼ Sec 36 T40 R4 except **a graveyard** on said premises containing 1 acre, also excepting a strip of land occupied by State Highway No. 110, and all that part lying SW of State Highway 110. Also excepting there from the east 450 feet of said E ½ SW ¼ of said Sec 36, said west line of said excepted tract being parallel to the east half of said SW ¼ and 450 feet there from." as recorded in Book 188 Page 522. (Highway 110 cuts across the SW corner of the original tract as can be seen in the Plat pictures above, here the Doctor buys all the land north of 110, except a strip 450 feet wide off the east side.)

Next I tried to find where Ben Jarvis and wife Irene transfer title to the next person. Again I lost the link and could go no further. So between 1925 when Henry Hodge owned the tract until whenever Ben Jarvis purchases it I could not locate any records. However we have proved the name to be Robertson Cemetery.

425

THE UNITED STATES OF AMERICA,

CERTIFICATE
No. *21051*

To all to whom these Presents shall come, Greeting :

WHEREAS *James B Bowlin of St Louis County Missouri*

has deposited in the GENERAL LAND OFFICE of the United States, a Certificate of the REGISTER OF THE LAND OFFICE at *St Louis* whereby it appears that full payment has been made by the said

James B Bowlin according to the provisions of the Act of Congress of the 24th of April, 1820, entitled "An act making further provision for the sale of the Public Lands," for the north east fractional quarter and the north half and the south west quarter of the north west quarter of section thirty five, and the north west fractional quarter and the east fractional half of the south west quarter of section thirty six, in Township forty of Range four East, in the district of lands subject to sale at *St Louis, Missouri*, containing two hundred and eighty one acres and twenty eight hundredths of an acre

according to the official plat of the survey of the said Lands, returned to the General Land Office by the SURVEYOR GENERAL, which said tract *has* been purchased by the said *James B Bowlin*

NOW KNOW YE, That the

United States of America, in consideration of the premises, and in conformity with the several acts of Congress, in such case made and provided, **HAVE GIVEN AND GRANTED,** and by these presents **DO GIVE AND GRANT,** unto the said *James B Bowlin*

and to *his* heirs, the said tract above described: **TO HAVE AND TO HOLD** the same, together with all the rights, privileges, immunities, and appurtenances of whatsoever nature, thereunto belonging, unto the said

James B Bowlin and to *his* heirs and assigns forever.

In Testimony Whereof, I, Franklin Pierce
PRESIDENT OF THE UNITED STATES OF AMERICA, have caused these Letters to be made PATENT, and the SEAL of the GENERAL LAND OFFICE to be hereunto affixed

Document 1

While searching for the tract the cemetery was on I originally thought it was on the *West* ½ of Section 36, this would be the J. W. Fletcher tract in 1876 and the H. Hamel tract in 1898. I did an abstract of this West ½ property and am including it here to possibly shed some light as to the *possible* origin of Robertson Cemetery.

This W fractional ½ of the SW ¼ the “meeting house” was located on was originally entered by **Richard Hendrickson** at the government land office in St. Louis on 10 December 1841 Certificate Number 10646 and comprised 38.08 acres. *see Document 2 below*;

On 23rd September 1843 Richard Hendrickson & wife Ellen sell the 38.08 acres “..with improvements where Richard Hendrickson now resides..” to Pascal H. Buren and William M^cKee for \$140.⁰⁰ as recorded in book F page 424.

8th February 1849 after owning the property for 5½ years Pascal H. Buren and wife Catherine, and William S. M^cKee and wife Mary sell the 38.08 acre tract to **John** Hendrickson for \$200.⁰⁰ as recorded in book I page 336.

16th October 1849 just 7 months later **John** Hendrickson (no wife listed) sells the 38.08 acres to **William** Hendrickson (no wife listed), the document is witnessed by **Lewis** Hendrickson, for \$225.⁰⁰ as recorded in book I page 547. William Hendrickson married Sophia Ogle on Thursday January 27, 1848.

6th January 1852 W^m. Hendrickson and wife Sophia obtain a promissory note in the amount of \$500.⁰⁰ from Louis Rankin & Thorton Jarvis using the following land as collateral; “...a tract containing 200 arpents off the north end of a tract of 1400 arpents confirmed to Walter DeWitt and Rufus Easton situated on the waters of the Joachim Creek, Jefferson County, same conveyed to Samuel Whitehead by Rudolph Haverstick & wife to said Hendrickson of the first part, *also W fractional ½ of the Southwest ¼ of Section 36 Township 40 Range 4 east.*” Payment of this loan was due in 1 year. Sophia Hendrickson evidently could not write as she signed the document with “her (X) mark”, as recorded in book K page 507.

1st June 1852 six months later, in the margin of the above book and page, is recorded a release of the loan signed by Louis Rankin and Thorton Jarvis (who signed with his mark).

21st March 1854 W^m. Hendrickson & wife Sophia sell the 38.08 acres to Louis Rankin for \$350.⁰⁰ as recorded in book M page 148 as follows “... the West fractional half of the Southwest Quarter of Section No 36 in Township Forty (40) of Range Four (4) East containing thirty eight acres and 08/100 of a acre more or less. ***Less one acre reserved for a meeting house and on which one now stands.***”

W^m. Hendrickson was a “Chaplain” in the Civil War according to his grave monument. It seems natural that he had a “meeting house” on his property. One must remember that this was

in the days before De Soto (1850s) was laid out and incorporated. This would be natural for a cemetery to be located next to a “meeting house”. The only problem at present is the warranty deed does not specify *exactly* where on the 38.08 tract this one acre is located.

I studied about 50 deeds to find the above mentioning of a church. When we revisited the cemetery I thought that possibly there was a church here as it seemed to me there were too many graves for a family plot. As to what church was there the only clue I have is a deed recorded on 5th March 1860 in which **Richard** Hendrickson is listed as a Trustee for the Methodist Episcopal Church. Could this be the same Richard Hendrickson that originally purchased the tract?

It is *my guess* that the following MAY have taken place. In the days before De Soto the people of the surrounding farms came together and erected a log church on the 38.08 acres. Richard or William Hendrickson was probably the pastor and “loaned” the property for the building. Later De Soto was laid out and developed and at some time the log church was destroyed, decayed or disposed of and the patrons elected to rebuild in the new town, which was about one mile away. This would be convenient for pioneers could pick up supplies after church. This new site, being in the city limits, did not have any grounds for burying members so they continued to use the old cemetery where the church was once located.

In a Vol. 8 No. 9 of the De Soto press dated 3 March 1900 an article states that the First Methodist Episcopal Church of De Soto dedicated a new church on Second and Boyd streets. “..for many years the congregation worshipped in the old church on East Main street, built by Rev. Samuel Huffman, in 1858...” If William Hendrickson deeded the “meeting house” in 1854 and Rev. Huffman built a church in 1858, this item is within the timeline. The old church site could have been abandoned between 1854 and 1858.

From an article in the Post Dispatch dated 8 April 1999, “... First United Methodist Church of De Soto, originally called First Methodist Episcopal Church, was organized three years before the start of the Civil War, at the corner of East Kelly and East Main streets.

In 1886, the Rev. D. W. Crow was appointed pastor and found his work cut out for him. The church had *lost numerous members in the war,...*”

I looked for deeds on the property up until 1870, this is when J. N. Whitehead was buried, so we know a cemetery was there at this time. After this time the 38.08 acres belong to Louis Rankin. De Soto was being developed by Rankin and Fletcher and the task becomes monumental as Rankin’s name is on most deeds to De Soto. Next I continued looking for Wm. Hendrickson name in the indexes as he legally still owned the land. Here again we run into too many deeds to search, for the time we had, as he is an early pioneer, civil war veteran, and it was the practice at the time to put money into land rather than a bank of which there were few to none. Next I tried to run J. W. Fletcher backward from 1876 with the same results. This ended my records search.

If anyone is able to shed more light onto the above story please contact me through the De Soto Library.

33,

CERTIFICATE
No. 10646

THE UNITED STATES OF AMERICA,

To all to whom these Presents shall come, Greeting:

WHEREAS *Richard Hendrickson, of Jefferson County, Missouri,*

has deposited in the **GENERAL LAND OFFICE** of the United States, a Certificate of the **REGISTER OF THE LAND OFFICE** at *St. Louis,* whereby it appears that full payment has been made by the said *Richard Hendrickson,*

according to the provisions of

the Act of Congress of the 24th of April, 1820, entitled "An Act making further provision for the sale of the Public Lands," for

the West fractional half of the South West quarter of Section thirty six, in Township forty, of Range four, East, in the District of Lands subject to sale at St. Louis, Missouri, containing thirty eight acres and eight hundredths of an acre,

according to the official plat of the survey of the said Lands, returned to the General Land Office by the **SURVEYOR GENERAL**, which said tract has been purchased by the said *Richard Hendrickson,*

NOW KNOW YE, That the

United States of America, in consideration of the Premises, and in conformity with the several acts of Congress, in such case made and provided, **HAVE GIVEN AND GRANTED,** and by these presents **DO GIVE AND GRANT,** unto the said *Richard Hendrickson,*

and to *his* heirs, the said tract above described: **TO HAVE AND TO HOLD** the same, together with all the rights, privileges, immunities, and appurtenances of whatsoever nature, thereunto belonging, unto the said *Richard Hendrickson,*

and to *his* heirs and assigns forever.

In Testimony Whereof, I, *John Tyler*

PRESIDENT OF THE UNITED STATES OF AMERICA, have caused these Letters to be made **PATENT,** and the **SEAL** of the **GENERAL LAND OFFICE** to be hereunto affixed.

GIVEN under my hand, at the **CITY OF WASHINGTON,** the *Tenth* day of *December*

in the Year of our Lord one thousand eight hundred and *forty one* end of the

INDEPENDENCE OF THE UNITED STATES the *Sixty Sixth*

BY THE PRESIDENT: *John Tyler*

By *J. Williamson* **RECORDER of the General Land Office.**

D. Tyler Sec'y



Document 2

The following stones were located in Robertson Cemetery and information from various sources;

HENDRICKSON, WM.

CHAPLAIN

31 Mo. Inf.

A *J. F. Hendrickson* is listed in the Jefferson County Veterans Records as being a Captain in the 31st Infantry Regiment Company A, as well as a *R. (Richard?) Hendrickson*, Union Army, and they were quite possibly related to William.

On 1876 T39 R4 Sec 1 you can see the area Wm. Hendrickson lived about a mile south of this cemetery across the valley.

Also Richard Hendrickson as above stated originally entered the tract of land just to the west of Robertson Cemetery.

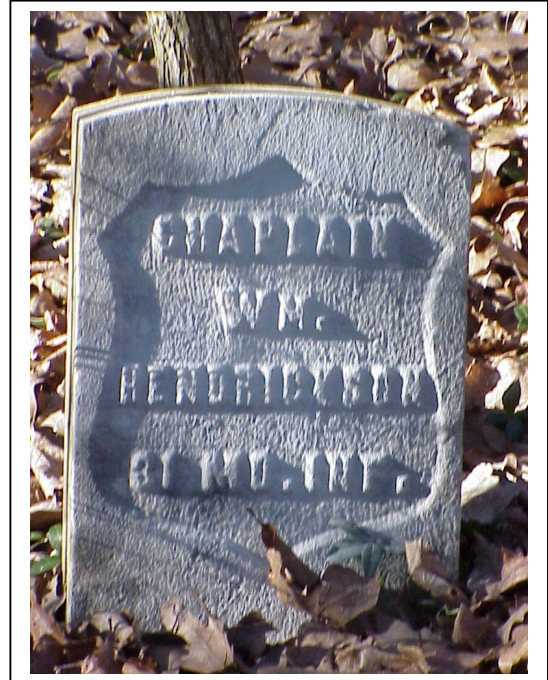

KYLE, J. T.

Co E

26th Mo. Inf.

A Thomas Kyle married a Mary Robertson on October 15, 1869. A John Kyle originally entered a tract of land in E $\frac{1}{2}$ SW $\frac{1}{4}$ T41 R4 Sec 27 Certificate # 13937 on Wednesday 23 March 1842. *These may or may not be this person.*

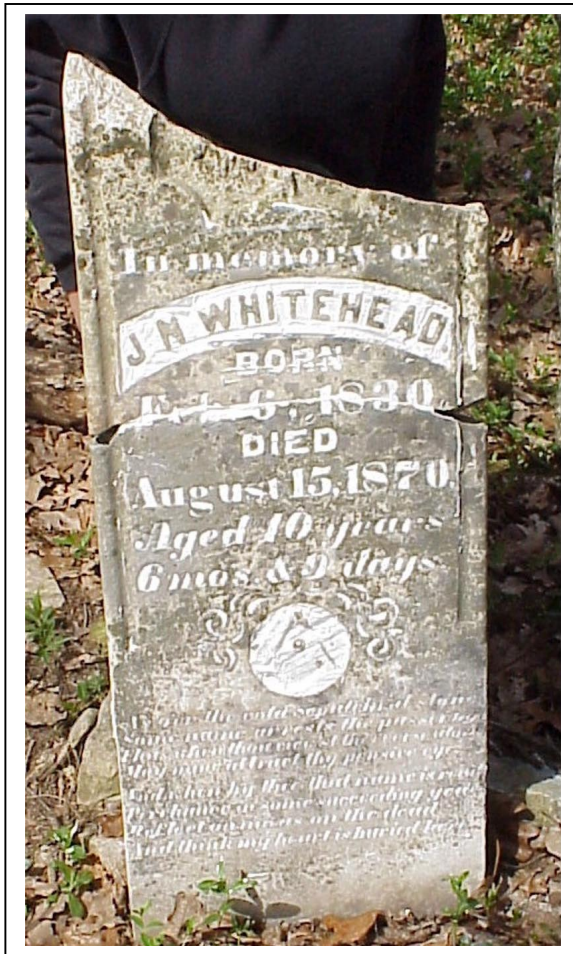

In memory of

WHITEHEAD, J. N.

Born
February 6, 1830

Died
August 15, 1870

Aged
40 Years 6 Months 9 Days

(Masonic Symbol)

As oer the cold sepulchral stone,
Some name arrests the passerby,
Thus when thou viewst verse above,
May thine attract thy pensive eye.
And when by thee that name is read
Purchase in some succeeding years,
Reflect a name on 'the dead
And think my heart is buried here.

Footstone J. N. W.

Many large loose stones laid around gravesite.

Top of stone broken but appears to be an eagle inside of a circle.

Records show a James N. Whitehead married Amanda Chrisman, Thursday July 12, 1866. The James N. Whitehead G.A.R. Post 171 in Victoria is *probably* named for this Civil War Veteran. This park is where the Old Settlers Association held many of their annual meetings and picnics. In 1866 James N. Whitehead appears on the registered voters list. In the 1876 Atlas J. N. Whitehead Estate owned 4 tracts of land comprising 357.15 acres.

RICHARDSON, JOHN W.

Co. B

57 ILL. Inf.

(Born Sunday)
August 4, 1844

(Died Wednesday)
January 17, 1923

(Aged 78 y 5 m 13 d)



A John Richardson appears on the 1866 voters list for Jefferson County. As is seen on the 1898 T41 R4 Sec 36 Atlas a J. W. Richardson owns 80 acres in T40 R4 Sec 36 the next property over from the cemetery. A John Richardson married Ida Geiger on Wednesday 17 September 1856. *These may or may not be this person.*



RICHARDSON,
ANNIE

(Born Saturday)
October 8, 1868

(Died Saturday)
February 7, 1903

(Aged 34 y 3 m 29 d)

RICHASON, PEARL

Born
(Saturday) June 21, 1890

Died
(Tuesday) July 24, 1894

(Aged 4 y 1 m 3 d)

Asleep in Jesus blessed sleep,
From which none ever wake to weep

At first I thought this was an error of the monument carvers, Richason instead of Richardson as this monument is next to the Richardsons, until I came across a license to marry in the 20 March 1890 Democrat that listed James Richason and Minnie E. Gowan. There are Gowans in T39 R4 Sec 1 next to William Hendrickson. Within a mile of the cemetery.

