

# Ulrich Cemetery

## German Evangelical Church Cemetery

By Dave Hallemann



This overgrown and neglected cemetery with its unusual history is located in T43 R5 S35 SW corner of the NE¼ of the NW¼.

38° 25' 26" N / 90° 26' 00" W

Visited 28<sup>th</sup> July 2004 by Dave Hallemann and Joseph Benedict. Originally recorded October 7, 1983, by Glee Heiligttag and Nadine Garland

This cemetery is on land first entered by Elijah Turner of St. Louis County Missouri on 10<sup>th</sup> January 1845, as certificate #12863 for the N½ of the NW¼ of S35 T43 R5 containing 80 acres.

On 22<sup>nd</sup> September 1851, Elijah Turner and his wife Deborah A., sell to John Ulrich for \$160.<sup>00</sup>, "N½ of the NW¼ of S35 T43 R5 containing 80 acres" recorded in Book L Page 78.

19<sup>th</sup> May 1854 John Ulrich and his wife Susannah of Jefferson County, sell for \$60.<sup>00</sup> to John Gilman and W<sup>m</sup> Richman, Trustees of the German Evangelical Church, "Begin at the SE corner of SW¼ S35 T43 R5 thence W 5 chains 72 links...thence N 38° 9 chains 13 links...thence S 39° 9 chains 20 links...thence W 5 chains 67 links to place of beginning...4 acres and 7 rods."

On May 24, 1934, recorded in Book 125 Page 555, the Circuit Court returns the following decision to resolve a suit of Ex Parte;

*Transcribed Circuit Court Record #16,156 Roll V Page 90A-B;*

*Chas. H. Edinger, Chas.  
Ulrich, Wm. H. Becker, John  
Schwalbert, Frank Schwalbert,  
and Harry J. Frederitzi,  
ex Parte,*

Comes now petitioners herein, in person and by attorney, and petition being presented to the Court, the Court doth find from said petition and the evidence adduced; that petitioner Chas. H. Edinger, Chas. Ulrich, Wm. H. Becker, John Schwalbert and Frank Schwalbert are descendents and representatives of the 13 families who on or about May 19, 1854, constituted themselves into an organization then as the **German Evangelical Church**; that the wife of John Ulrich, Sr. was one of the members of said organization and constituted one of the said 13 families; that John Ulrich, Sr., who was not a member of said organization, and who owned the fee simple title to the north half of the northwest quarter and the southeast quarter of the northwest quarter of section thirty-five (35), Township forth-three (43), Range five (5 )east, for the purpose of providing a place of worship for said organization, by warranty deed May 19, 1854, recorded in the Recorder's office of Jefferson County, Missouri, in Book M Page 116, attempted to convey to John Gillman and William Richman, as trustees of the German Evangelical Church, for the sole use and benefit of said church, the following described piece or parcel of land, to-wit; Beginning at the S. E. corner of the S. W. q. of the N. W. q. of Sec. 35, T. 43, Range 5 E; thence w. 5 chains & 72 links, a black oak 18 inches diameter bears north; thence N. 38 degrees E 9 chains and 13 links a white oak 18 inches dia. bears N. 52 degrees W. 7 links dist. a w. o. 16 inches dia. bears south 35 degrees E. 35 links distance; thence south 39 degrees E. 9 chains & 20 links a hickory 10 inches diameter bears N. 79½ 17.34 links dist. A black o. 11 inches diam. S. 85½ W. 24 links dist; thence W 5 chains and 67 links to the place of beginning, **containing four acres and seven rods that said John Ulrich, Sr. did not own**, the southwest quarter of the northwest quarter of said section 35 out of which the west part of said four acres is described. Petitioners aforesaid, further state, that the members of said German Evangelical Church, did not then and never have taken or attempted to take possession or of use the premises described in said warranty deed; that the said members of said German Evangelical Church did deliver some building material on the tract of land in the southeast corner of the northwest corner of the northwest quarter and the southwest corner of the northeast quarter of the northwest quarter of section 35 but **never erected any building thereon and never used said premises for religious or church purposes in any way whatever**; that upon the death of some of the members the **families constituting said German Evangelical Church, they buried such deceased members on a portion of land** situated in the Southwest corner of the northeast quarter of the northeast quarter of said section 35 and said deceased relatives have continued to be buried there since that time; that said German Evangelical Church organization **long since ceased to exist** or assert any right or control over either the tract described in said above mentioned deed or the tract last above referred to on which the dead are buried, **except as a burying ground is but a fraction of an acre**; that there is no one if the community who use this tract as their regular burying ground and that the space of one acre will for more than suffice for the purpose of a burying ground or cemetery for all time to come; that **petitioner Harry J. Frederitzi has acquired title to all the land owned by the above mentioned John Ulrich, Sr., "except" about four acres reserved for cemetery**; by virtue of the sheriff's deed on partition conveying the said real estate to Frank Dietrich who in turn quit claimed said real estate to Harry J. Frederitzi; that in making the reservation of said four acres in said partition proceedings and in said sheriff's deed there under, it was the intention to except the four acres to the Trustee's of the German Evangelical Church as aforesaid; that said petitioner Harry J. Frederitzi and those under whom he claims title have been in the open,

*notorious, adverse, continuous and exclusive possession of all of said real estate, except that part used as a burying ground for more than 50 years last past; that said Harry J. Frederitzi agrees here in open court that the court decree one acre of land including the graves now located thereon for a family cemetery for the use and benefit of the families having their dead buried thereon, which acre of land is to be described as all that part of the northeast quarter of the northwest quarter of section 35, Township 43, Range 5 east, lying south of the county road; the east line of which is to be parallel with the west line said northeast quarter of the northwest quarter and far enough east from said west line to include one acre and no more.*

*It is therefore **considered, ordered, decreed, and adjudged that the warranty deed dated May 19, 1854, recorded in Book M at Page 116, from John Ulrich, Sr., and wife to John Gilman and William Richman, as Trustees for the German Evangelical Church, be and the same is declared to be null and void and on no effect; that the title sought to be conveyed by said deed , except one acre, be vested in fee simple in Harry J. Frederitzi; that the title to all that part of the northeast quarter of the northwest quarter of Section 35, Township 43, Range 5 East, lying south of the county road and bounded on the east by a line running parallel with the east line of said northeast quarter of the northwest quarter of Section 35, Township 43 Range 5 East and for enough east from said west line to include one acre and no more, be vested in the County Court of Jefferson County, in trust for the purpose of a family burying ground to be held by said court under the provisions of Section 14053 and 14054, R. S. of Mo. 1929.***

This decision by the court declares that the 4+/- acres deeded for church be rescinded, and 1 acre for a family burying be set aside for the 13 original families that formed the German Evangelical Church. The remaining 3 +/- acres be vested in Harry Frederitzi.

With this court order we cannot assign the name of German Evangelical Church Cemetery as the attempt to construct the church was unsuccessful. And as John Ulrich's wife being one of the 13 original families, and this cemetery is commonly known as Ulrich Cemetery in records such as the History of Arnold, we also will give it the name of **ULRICH CEMETERY.**

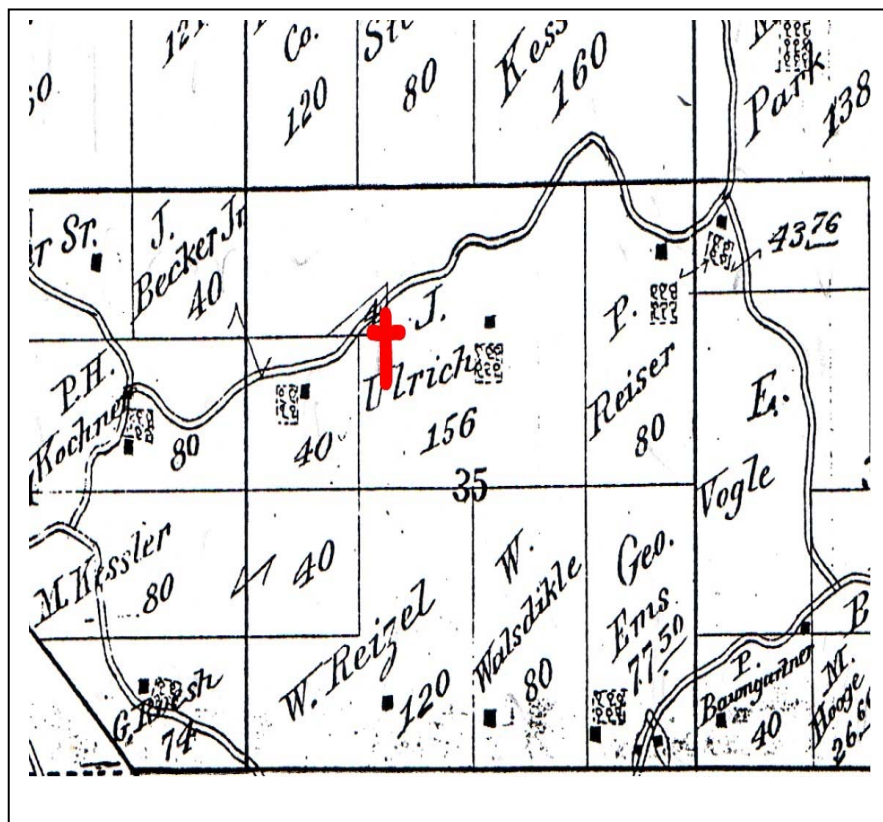

As can be seen in the picture at left, in 1876 there is a 4 acre triangle with the cemetery on the east side of the road. J. Ulrich's lands surround the property. The cross I added to the photo to denote the approximate location of the cemetery.

By 1898 J. Ulrich SR. still owns the surrounding lands. Note the church designation on the map. There never was a building erected. The map maker was working off deeds. As before I added the cross to show location.

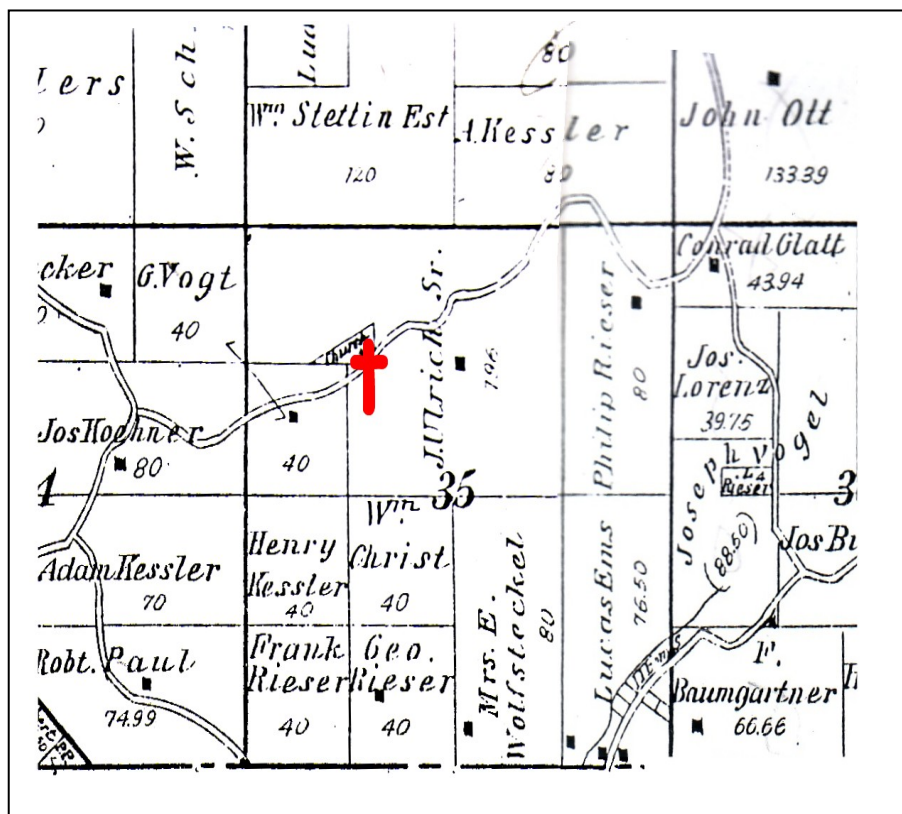



The Following monuments were recorded in my visit of July 2004;



## HAYS

Emily	Carl	Edward
1837-1910	1832-1900	1867-1927
Mother	Father	Son

## KAISER

John M.

1862-1939

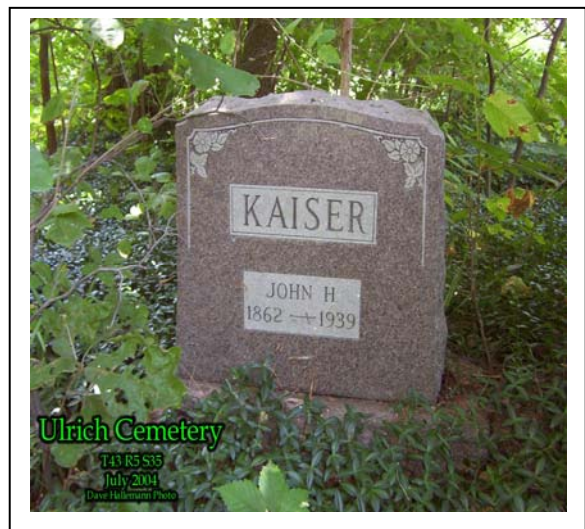

Heir Ruht in Gott  
Unsere Mutter

Elisebeth

## SCHWALBERT

Feb. 16, 1827  
Nov. 26, 1913



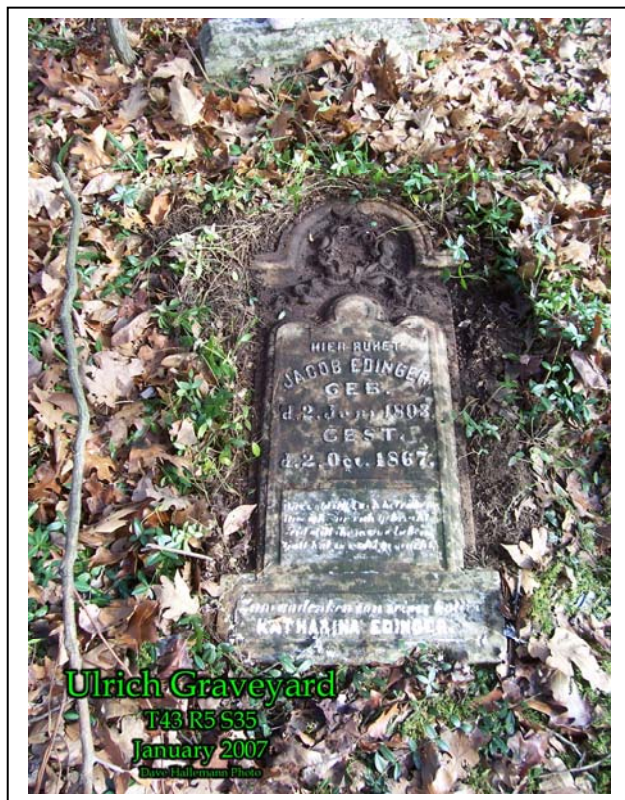

Hier Ruhet  
**JACOB EDINGER**

Geb  
d. 2 Juni 1803

Gest  
d. 2 Oct. 1867

(German Verse)

(?) von Seiner Gotten

Katharina Edinger

Hier Ruhet  
**Katharina  
EDINGER**

Gest.  
d. 28 Juli 1874

Im Alter von  
57 Jahren

(In older of 57 years)  
(Monument broken into three pieces)







## LUDWIG STORH

Geb. 7 Jan. 1831

Gest. 26 Mar. 1911

## FRANZ SCHWALBERT

Name from a 1982 recording  
by matching dates

17 July 1826

Gest.  
29. Oct. 1870



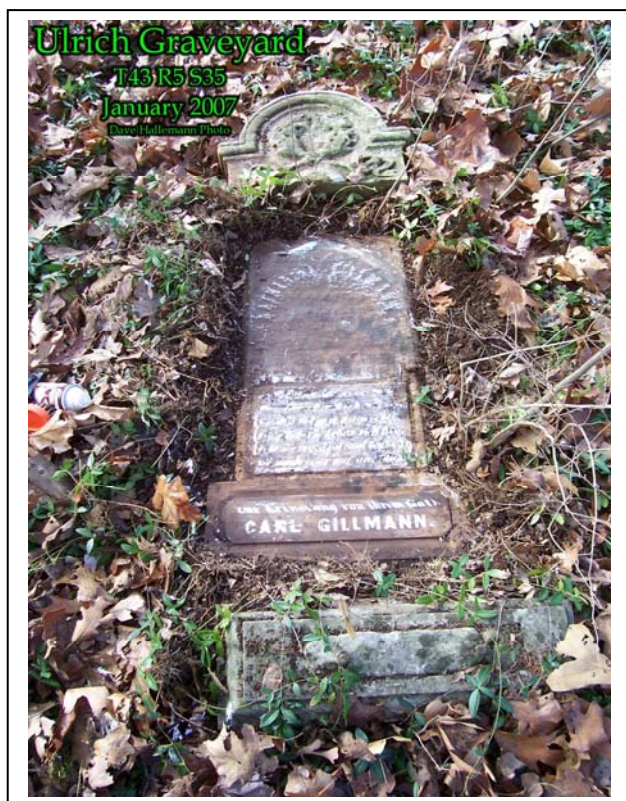

# KATHERINA GILLMANN

Geb  
d. 18 April 1830

Gest  
d. 17 February 1883

(Dates from 1983 recording, unreadable 2007)  
(German Verse)

Tur Grinerang von ihren Gotte (?)  
Carl Gillmann

(Monument broken into three pieces)

On a revisit January 7, 2007 with Carole Goggin we located another buried monument base away from the others. The monument was not located as we did not have our probes and digging tools. We did find a foot stone. We plan to revisit in the future and try to locate this monument with any others.





List from the 1983 recording;

Edinger, Katharina, d. July 26, 1874, 67 Yrs. (*This should be 57*)  
Edinger, Jacob, June 2, 1803, Oct. 2, 1867  
Geib, Peter, d. Nov. 23, 1884, Age 63 yrs  
Gillmann, Carl, no dates  
Gillmann, Katharina, April 18, 1830, February 17, 1883  
Gillmann, Karl Joseph, Sept. 18, 1871, Feb. 8, 1872  
Hays, Carl, 1832-1900  
Hays, Edward, 1867-1927  
Hays, Emilie, 1837-1910  
Kaiser, John H., 1862-1939  
Schwalbert, Elisabeth, Feb. 16, 1827, Nov. 26, 1913 (*There is an Elisabeth Schwalbert with the same death date listed in St. John's Lutheran Cemetery, unknown if grave was moved*)  
Schwalbert, Franz, July 17, 1826, Oct. 29, 1870  
Storh, Ludewig, Jan. 7, 1831, March 20, 1911

(Possible footstones)

G. K.

R. M.

Copyright © 2007 Dave Hallemann

*This article can **not** be used for commercial purposes or distributed for a fee;  
may be distributed in any form for personal, historical, or genealogical use;  
and the author must be given credit.*