

Ogle Graveyard

By Dave Hallemann



This overgrown cemetery with its beautiful old monuments and wrought iron fencing with outstanding gate is located in T40 R5 S18 Survey 2978.

38° 12' 4" N / 90° 30' 13" W

This cemetery was visited by Jerry McKee, Sharon Uding, and Dave Hallemann on the 19th June 2001.

This Cemetery is also known as Ogle-Null Cemetery in various records. It was probably named that by early researchers as

Ogle owned the property in 1876 and Null owned it in 1898, according to the Atlas'. As we will show this cemetery should be named for George Washington and Hannah D. Ogle.

This cemetery is along the backside of an original U. S. Land Survey #2978 which was originally granted to John Connor under Isaac Van Meter. U. S. Surveys were land grants, either Spanish or French, which were confirmed by the United States Government after the Louisiana Purchase to person who could prove a valid claim. This Survey encompassing 640 acres has the town of Hematite and the Joachim creek in it.

On the 15th of January 1830 Katherine Connor, wife of John Connor, deceased, sells a portion of the Survey to Armstrong Connor, for \$300.⁰⁰, "...being bounded by land owned by Pleasant C. Connor, which said land was deeded to Pleasant C. Connor by John Connor in the year 1828, (likewise?) William Null's survey, it being the upper end of said section of congress lands..." as recorded in Book C at Page 144.

Just 18 days later on 2nd February 1830 we find Armstrong Connor and his wife Unity transferring ownership of the tract to Thomas Ogle, all being of Jefferson County, for \$320.⁰⁰, "...situated and lying on the Joachim Creek, in the County of Jefferson and State of Missouri, being the upper half of a tract (*here the 'upper tract' is actually on the southern end as this refers to the direction the Joachim Creek flows*) originally confirmed to John Connor containing 640 acres adjoining Wm. Null and others, and conveyed by John Connor, by his last will and testament, to his wife Catherine Connor, and by said Catherine Connor conveyed by deed bearing date of 15 January 1830 to Armstrong Connor which by (reference?) being made to said deed will more fully appear..." as recorded in Book C at Page ???.

13th September 1843 after retaining ownership of this tract for more than 13 years Thomas transfers ownership to his two sons Henry and George Washington Ogle, for services, love and \$1.⁰⁰, "...320 acres situated, lying and being on the **Swashin** Creek in Joachim

Ogle Graveyard

Township, Jefferson County, State of Missouri, it being the West ½ of 640 acres of land bounded East and South by lands of Wm. Null Sr. and Wm. Null Jr., West by lands originally owned by Phillip Roberts, and North by lands unknown, in Survey 2978 in Township 40 Range 5....”, as recorded in Book F at Page 446.

In Book L at Page 320 we find Henry Ogle transferring “...all right, interest, and claim...” to George W. Ogle and his wife Hannah, for \$950.⁰⁰.

Last we find, in the will of Hannah D Ogle, recorded in Book 12 at Page 237, on December 6th, 1877;

In the name of God Amen;

“I Hannah D. Ogle of Jefferson County, Missouri, do make and publish this my last will and testament, and dispose of all my worldly property in manner following;

1. I commend my soul to God who gave it and I direct that my remains be buried beside my late husband *in a coffin to cost at least one hundred and fifty dollars, in clothing to correspond;*
2. I give, bequeath, and deed to the County Court of Jefferson County, Missouri, one acre of ground to be taken in the shape of a perfect square, its lines to run north and south, with the grave of my late George W. Ogle to be taken as the center thereof, which is situated on the farm of which my homestead is situated, to have and to hold its said acre of land unto said County Court forever, for a public burying ground and cemetery, and my executor hereinafter named is directed, as soon as convenient, after my death, to have said acre of land surveyed and the lasting corners thereof established;
3.(here Hannah divides the remainder of her estate to various person)

With this document we establish the “official” name of this cemetery as the “Ogle Graveyard”.

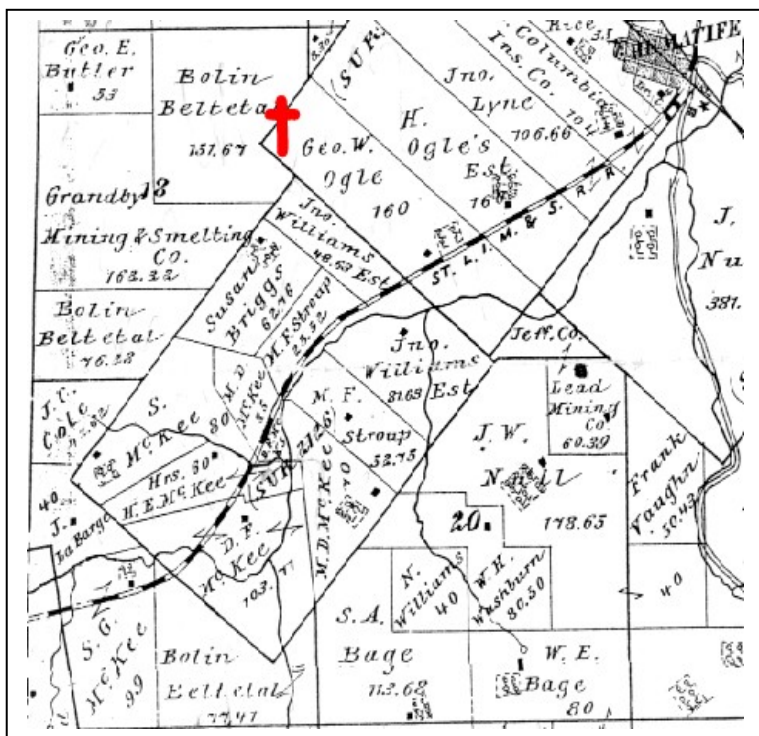

As can be seen in the picture at left, in 1876 George W. Ogle has possession of the property.

The graveyard sits where I have added the red cross.

Note all the Henry Ogles Estate owns the other 1/2 of the 320 acres given to them by Thomas Ogle. Also note the "dashed" line is the Railroad tracts and not the roadway.

In 1898 the J. W. Null, who could be the J. Wesley Null buried in this graveyard, now owns this tract.

In 1898 we see a roadway has been established in this area, and the Ogle homestead sat between the railroad tracts and the roadway.

Again I have added the red cross to denote the approximate location of this cemetery.



Ogle Graveyard

The following pictures are of the monuments in this cemetery. The clarity of the lettering on the photographs is due the "shaving cream" method. In this cemetery there are depressions, flowers, and many fieldstones, which denote unmarked graves.

Geo. W. Ogle

Born
August 22nd, 1825

Died
January 18th, 1877

Aged
51 Years 4 Months 26 Days

*This languishing head is at rest; his thinking and
aching are o'er; this quiet memorable breast; is
marred by affliction no more.*

Footstone G. W. O.



Han. D. Ogle

Born
January 19th, 1826

Died
December 7th, 1877

Aged
51 Years 10 Months 18 Days

Footstone H. D. O.

Ogle Burial Plot

This is the George Washington and Hannah D. Ogle burial plot within Ogle Graveyard, with its wrought iron fencing.



The picture at left shows the symbolism that appears on this monument. The hands at top, with mans fingers pointing to George on left, as denoted by cuff of sleeve and size of hand, and woman's fingers pointing to Hannah on right.

Picture at top shows the extremely ornate gate, with weeping angel, and corner post surrounding this plot.

NULL

Sophronia
(*nee Vinyard*)

1848-1918

J. Wesley

1852-1934

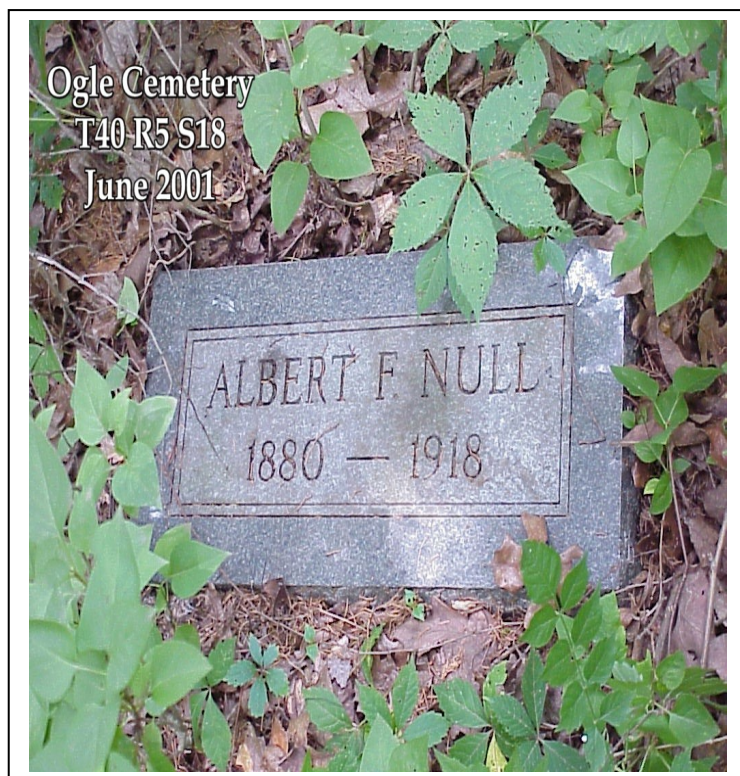
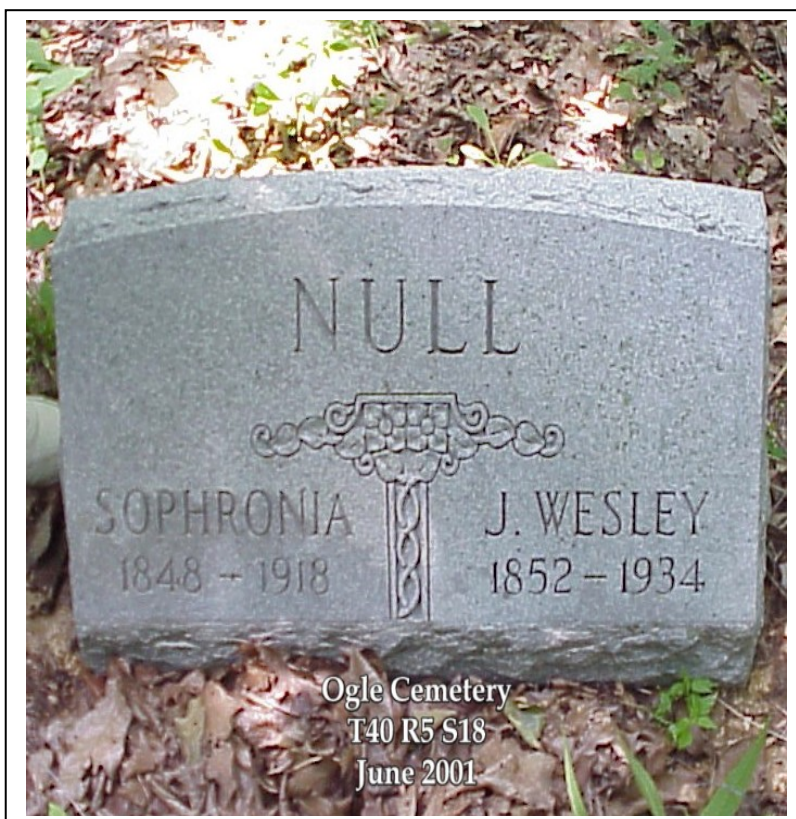

Albert F. Null

1880-1918

Clementine

Daughter of J. W. & S. Null

(Born)
August 18th, 1878

(Died)
June 23rd, 1911

Gone but not forgotten

Aged 32y 10m 5d

Dove with leaves at top

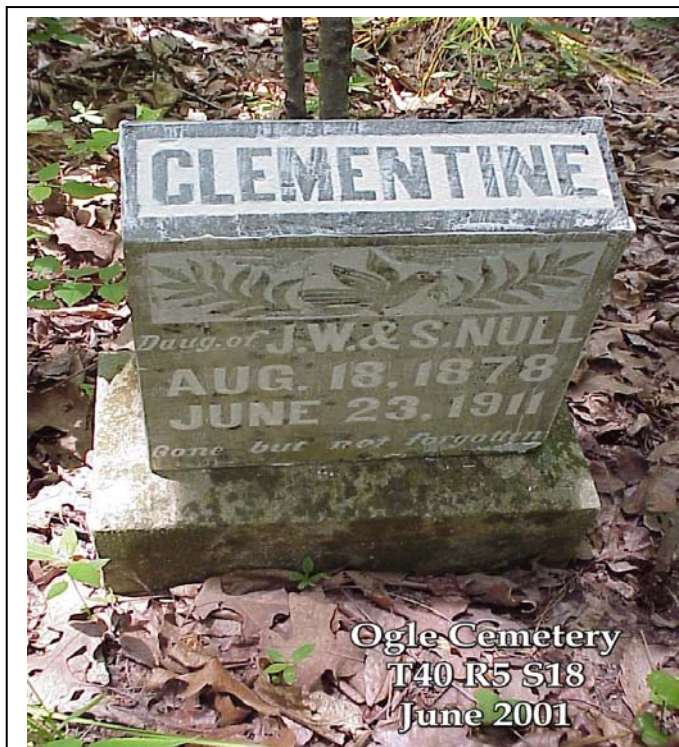

Alice M.

Daughter of
B. F. & Elizabeth
M^cKee

Born
November 19th, 1878

Died
February 25th, 1879

*Suffer little children to come to me and
forbid them not, for such is the kingdom of
heaven,*

Aged 3m 6d

Circle with dove at top

Sarah E. Scott

Born
December 7th, 1856

Died
March 8th, 1880

Gone to rest

Aged 23y 3m 1d

Circle with dove at top

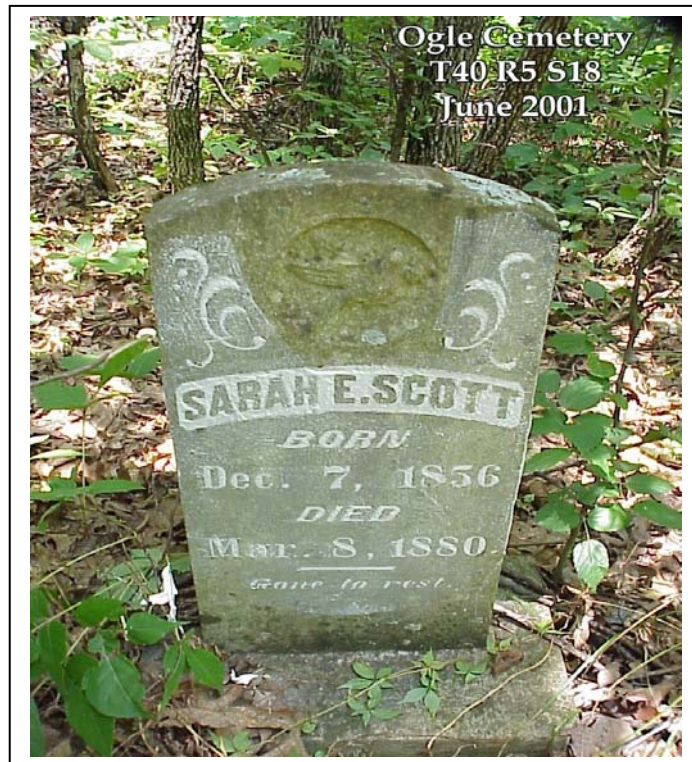

J. Newton SCOTT

Born
June 29th, 1890

Died
August 8th, 1899

Gone but not forgotten

Circle with lamb at top

Aged 9y 1m 10d

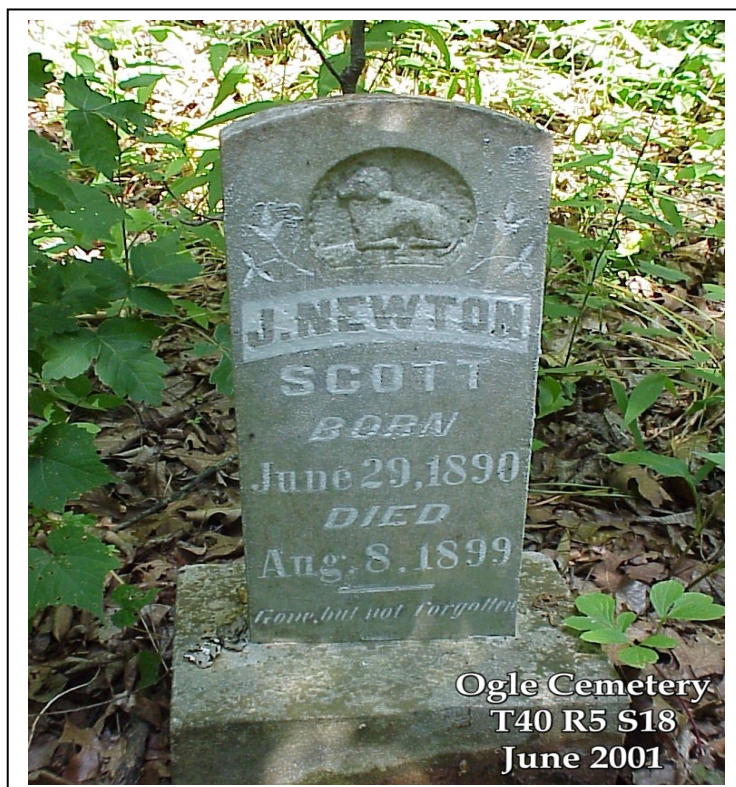

**Sarah E.
SCOTT**

Born
November 7th, 1898

Died
March 12th, 1899

Gone but not forgotten

Aged 4m 5d

Circle with lamb at top

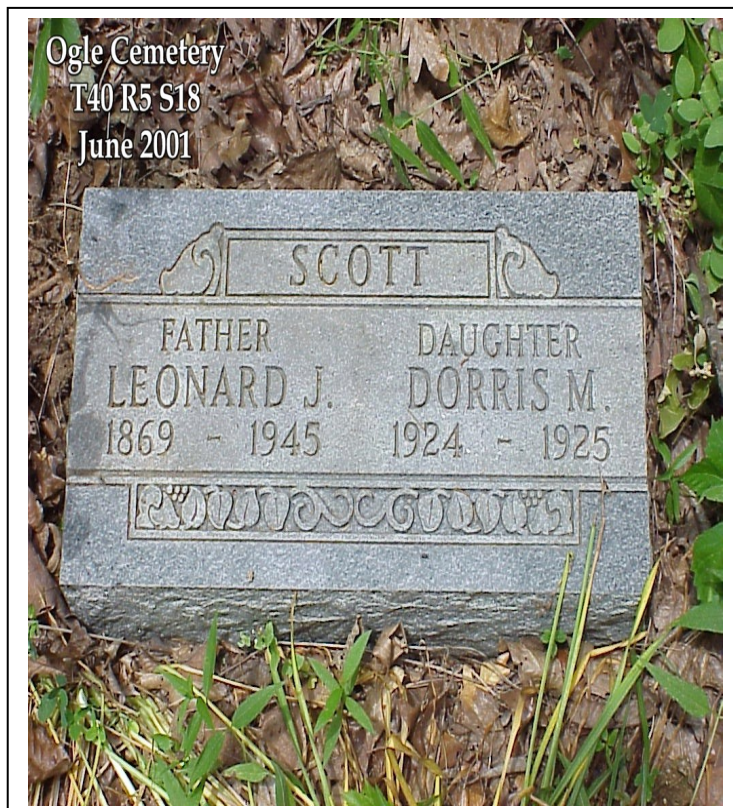

SCOTT

**Father
Leonard J.**

1869-1945

**Daughter
Dorris M.**

1924-1925

Delphine Williams

(Born)
February 25th, 1917

(Died)
November 29th, 1921

Aged 4y 9m 4d

*Barnhart Funeral Parlor of De Soto list Delphine's
parents as Edgar & Victoria. She died of Dipthera
at age 5.*

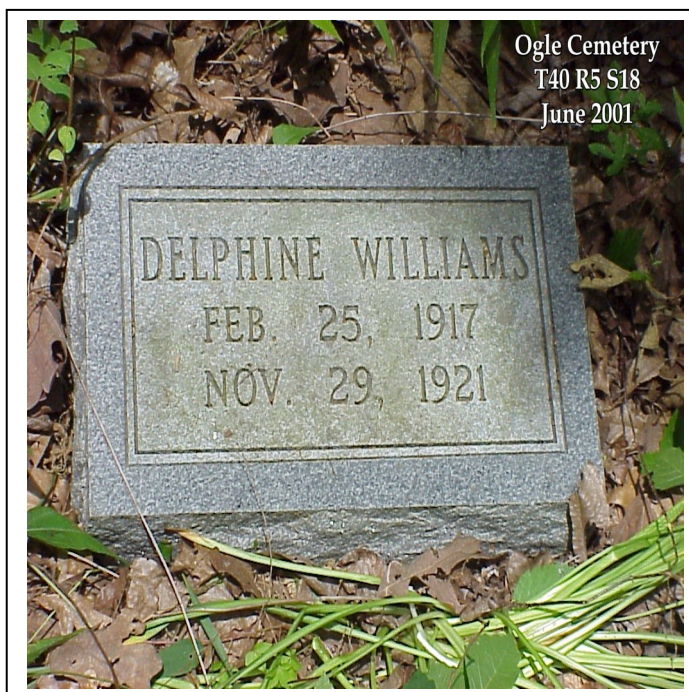

Infant son of

**M. T. & A. B.
M^cCormack**

Born & Died
October 25th, 1902

*Budded on earth to bloom in
Heaven.*

Circle with dove at top

Anna Hammond

April 15th, 1923

Our records from the 1980s survey show that Mary Hammond b.10-06-1897, and Mary Anna Hammond aged 6m, died the same month and was buried on top. There is faint lettering below ground level on this hand made monument.



Unknown

There are many unknown graves in this cemetery. Many are denoted by a large head and footstone. Also one funeral marker was located.

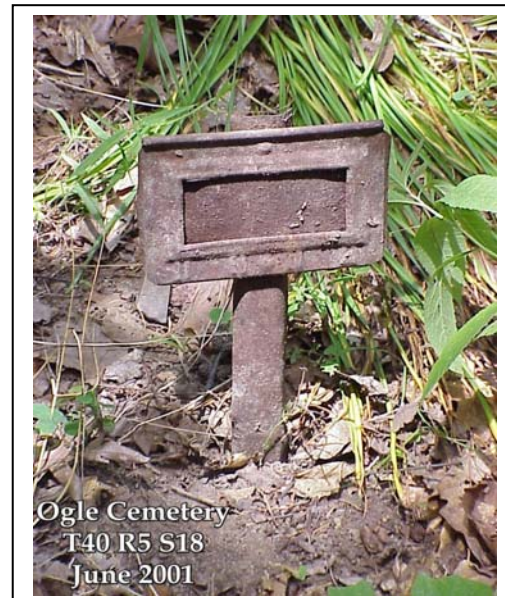
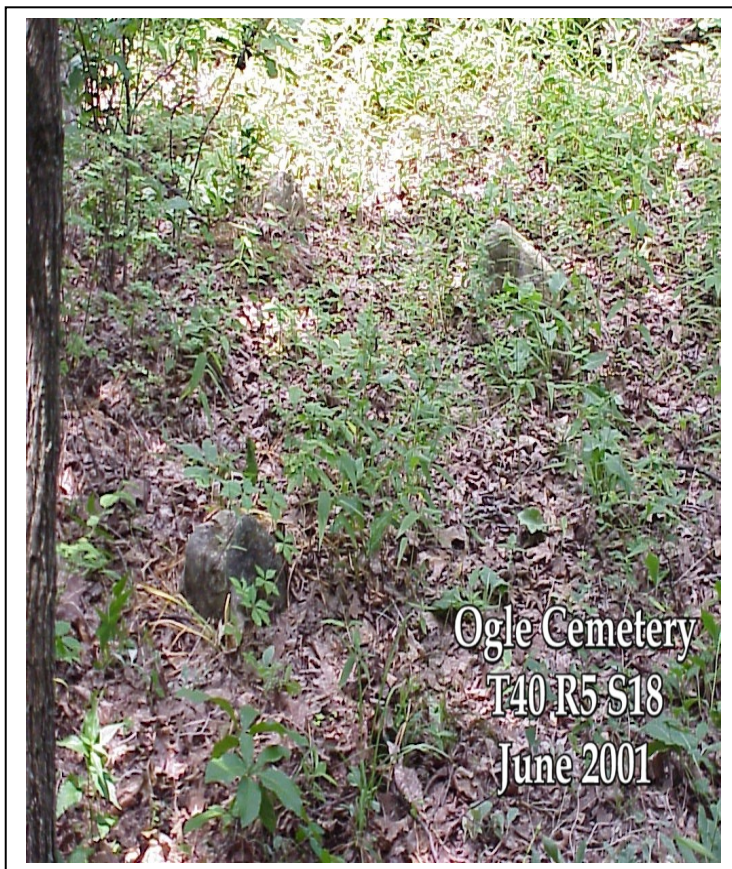

Listed with the persons above from our records are the following persons buried in this graveyard. The information was probably supplied from family members or someone who has records of this public graveyard.

Dickens, Mabel Adela	10-18-1893	09-19-1918	L.J.&M.S.
Gault, Nancy Emeline	10-21-1858	10-19-1943	
Fields, Nancy Ann	07-06-1831	01-20-1902	Phoebe/Scott
Frances, Sarah E.	12-07-1856	03-28-1880	Wm&P.A.
Hamman, Mary	04-15-1923 age 6m	1923	Mary Anne
Hammon, Mary Anna Scott	10-06-1897	04-15-1923	
McCormack, Infant son	10-05-0902	10-25-1902	M.T.&A.B.
McKee, Alice M.	11-19-1878	02-25-1879	D.F.father & Elizabeth
Null, Albert F. 1880	1918		
Null, Clementine	08-18-1878	06-28-11	J.W.&S.
Null, Sophronia nee Vinyard	age 72	03-31-1918	
Null, J. Wesley (Sophronia)	1852	1934	
Ogle, George W.	08-22-1825	01-18-1877	
Ogle, Han D. 01-19-1826	12-07-1877	wife of George W. 51y, 10m, 18d	
Ogle, Sophronia	1848	1918	
Reynolds, Infant	nd	nd	Thomas
Reynolds, Infant	nd	nd	
Scott, Dorris Marie	12-05-1924	09-01-1925	L.J.&Lucy
Scott, Gertrude	12-19-1906	01-05-1907	L.J.&M.S.
Scott, Herman Jackson	09-01-1904	07-24-1920	L.J.&M.S.
<i>Coxwell Funneral Parlor records list the following; SCOTT, Herman S., 7-24-1920, 16 yrs.</i>			
<i>Ogle; Cem, Struck by lightning</i>			
Scott, Homer 18 yrs	nd		
Scott, J. Newton	06-29-1890	08-08-1899	S.S.&M.
Scott, Leonard Jackson	09-25-1869	05-30-1945	W.N.&P.A.
Scott, Louise Margaret	nd	reburied in Woodlawn	
Scott, Mary Meesey (Stephen)	nd	nd	

Ogle Graveyard

Scott, Mary Sophronia (L.J.)			
Scott, Sarah E. 11-07-1898	03-12-1899	S.S.&M.	S E S footstone
Scott, Sarah E. 12-07-1856	05-08-1880		
Scott, Stephen Smith (Mary M)	1866	10-25-1906	
Scott, William Newton (Phoebe)	01-10-1831	04-17-1908	
Scott, Child		7-1-1925	
8 months old, child of L. J. & ? (Cundruff) Scott, died of dysentery per Barnhart Funeral Parlor of De Soto Records			
Williams, Delphine Edna	02-25-1917	11-29-1921	

Copyright © 2001 Dave Hallemann

*This article may be distributed in any form as long as there
is no fee charged, and the author is given credit.*